

How to Copy Custom Lead Fields to Contacts

Step: 1 Run the a Database Query to copy the tables over from LEADS to CONTACTS

```
insert into fields_meta_data
select concat('Contacts', name), name, vname, comments, help, 'Contacts',
type, len, required, default_value, date_modified, deleted, audited,
massupdate, duplicate_merge, reportable, importable, ext1, ext2, ext3, ext4
from fields_meta_data
where custom_module='Leads' and name not like 'jjwg%';
```

Step 2: Copy Field Labels

Then you need to copy the field labels:

You will then need to copy the field labels from

```
custom/Extension/modules/Leads/EXT/language/_override_en_us.lang.php
```

and merge them into

```
custom/Extension/modules/Contacts/EXT/language/_override_en_us.lang.php
```

Step 3: Copy the Vardef files

If there are a lot of custom fields for Leads that need to be created in contacts you can copy the Vardefs.

- Copy the vardefs folder from /custom/extension/modules/{module name=LEADS}/Ext/Vardefs
- Copy to a folder on desktop. Use Notepad ++ and search and replace in folder to replace "Lead" with "Contact" in the files definitions.
- Copy the edited files back to the server in /custom/extension/modules/{module name=CONTACTS}/Ext/Vardefs

(note do not copy the jjmaps fields just leave as is)

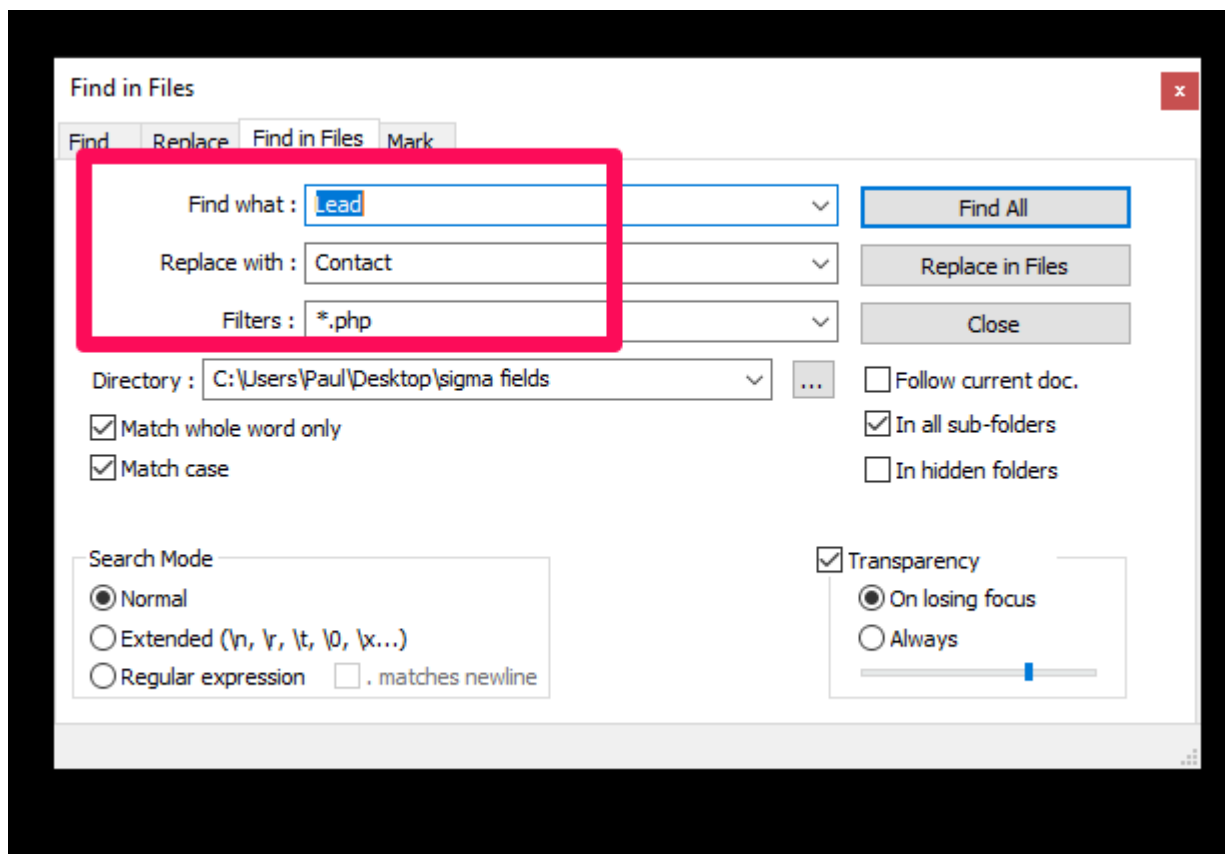

Step 4: Quick Repair and Rebuild

From:
<https://igo.myqnapcloud.com:8081/igodokuwiki/> - iGoWIKI

Permanent link:
https://igo.myqnapcloud.com:8081/igodokuwiki/doku.php?id=production:sugarcrm:development:copy_lead_fields_to_contacts

Last update: 2024/04/25 22:24

